



AUXILIARY PPE GEAR

Survival (SAR) VEST



Lightweight, ruggedly built nylon mesh vest designed to provide stowage for survival (PPE) items.

SAR Vest Equipment and Location

Each item must be in the correct pocket as shown below

1. Emergency Signaling Mirror

2. Signal Whistle

3. Marine Smoke and Illumination Signal
(Not Aux)

4. Illumination Signal Kit
(Not Aux)

5. Distress Signal Light

6. Survival Knife (Opt)

7. Personal Locator Beacon (PLB)



SAR Vest Outfitting

- SAR vest not required. Optional for those who switch between PFD, float coat, or Work suit (Hypothermia coveralls).
- The Survival Vest **IS NOT A FLOTATION DEVICE and MUST be worn over your PFD (Type III)!!**
- Each item must be in the described location in every vest.
- Each item is standardized and outfitted according to the Rescue and Survival Manual
- Each item is required to be tethered to the vests pocket with a nylon cord lanyard.
- **Not to be worn with an inflatable PFD (Type II).**



#640 Sirius LED Strobe Light

- Dimensions: 4.6 x 2.0 x 1.1 inches (L x W x H)
- Weight: 3.3 ounces (typical with batteries).
- Visible from 2-5 miles, subject to atmospheric conditions.
- Strobe flash rate of 60 +/- 5 flashes per minute.
- Operational/Battery life: Minimum 8 hours continuous per USCG approval requirements. Typical 20+ hours.
- Battery Type: Two dated AA alkaline or lithium batteries (batteries not included). **Lithium** recommended for cold environments.



#231 Cyalume®

PML Chemical Light

The Personnel Marker Light (PML) is a safe chemical light approved by the USCG and the FAA for use on life preservers. Squeeze handle to activate. When activated, the PML emits a yellow-green glow which lasts for a minimum 8 hours & is visible up to 1 mile on clear, dark nights.

A superb emergency light source for life preservers as it is waterproof, windproof, nonflammable, easy to activate, and requires no batteries.

Four year shelf life.

Optional item.



#4220 01 27803007

Survival Knife

The basic survival tool. A high quality, compact, lightweight, snag and corrosion resistant knife manufactured by LSC. This knife has a razor sharp, 4" mirror finish stainless steel blade with **blunt tip**. The upper edge of the blade is serrated and features a line cutter.

Handle is constructed of sure-grip ABS plastic with a lanyard hole. Includes rubber belt sheath with integrated safety retainer.

Do Not sharpen tip of knife!

Not required. Folding knife may be used.



ACR PLB

- Manually activated
- Test Once per Month
 - Only 60 tests over 5 year Battery life
 - Command approval required to test
- 24 hour transmission life
- Registered to CG Station, assigned to Flotilla by district/sector



ACR PLB Self Test

A. Release the pop up antenna and move it to the upright/vertical position exposing the power and test buttons.

B. Depress the Test button (adjacent to the blue T arrow for one second.

C. The Green LED under the transparent cover will illuminate for 2 seconds indicating a successful GPS test.

D. The self test should be executed between on the hour and 5 minutes after the hour.

E. The PLB battery has a counter which allows for 60 tests over the 5 year life of the battery (i.e.: 1 per month)



Fast Find 220 PLB

- Test Once per Month
 - Only 60 tests over 5 year Battery life
 - Command approval required to test (RSS Officer request)
- 24 hour transmission life
- Registered to CG Station, assigned to Flotilla by district/sector



Manual Activation

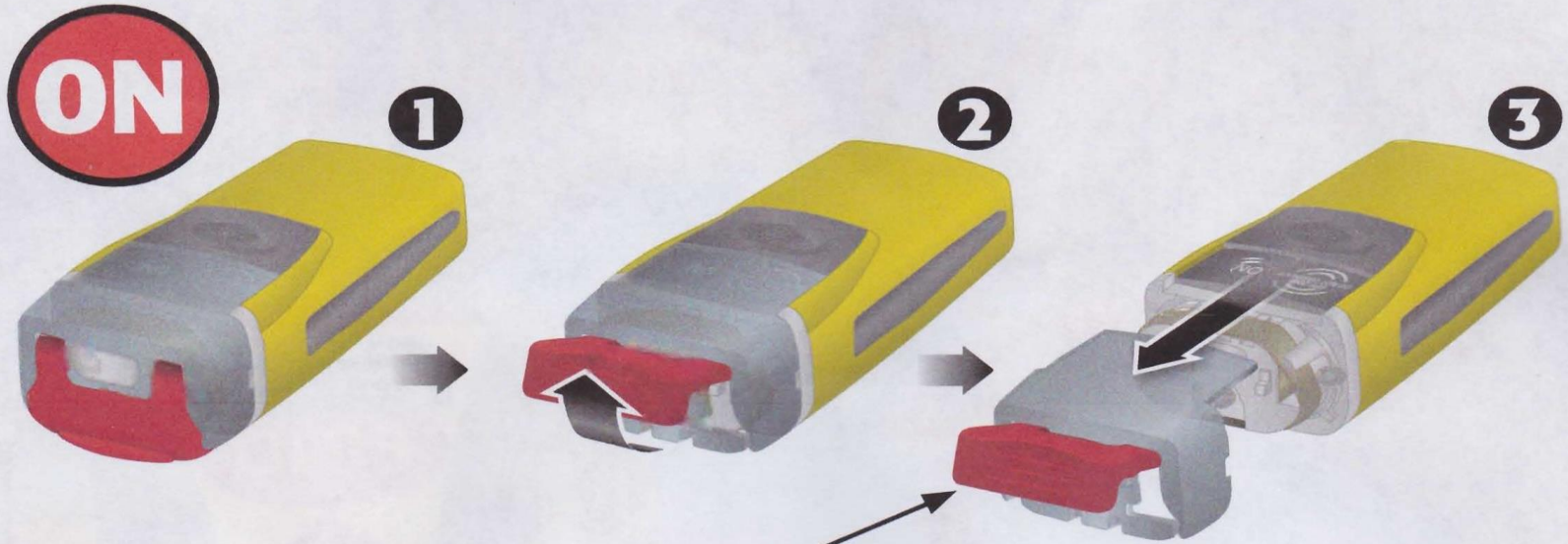

ONLY PULL IN AN EMERGENCY

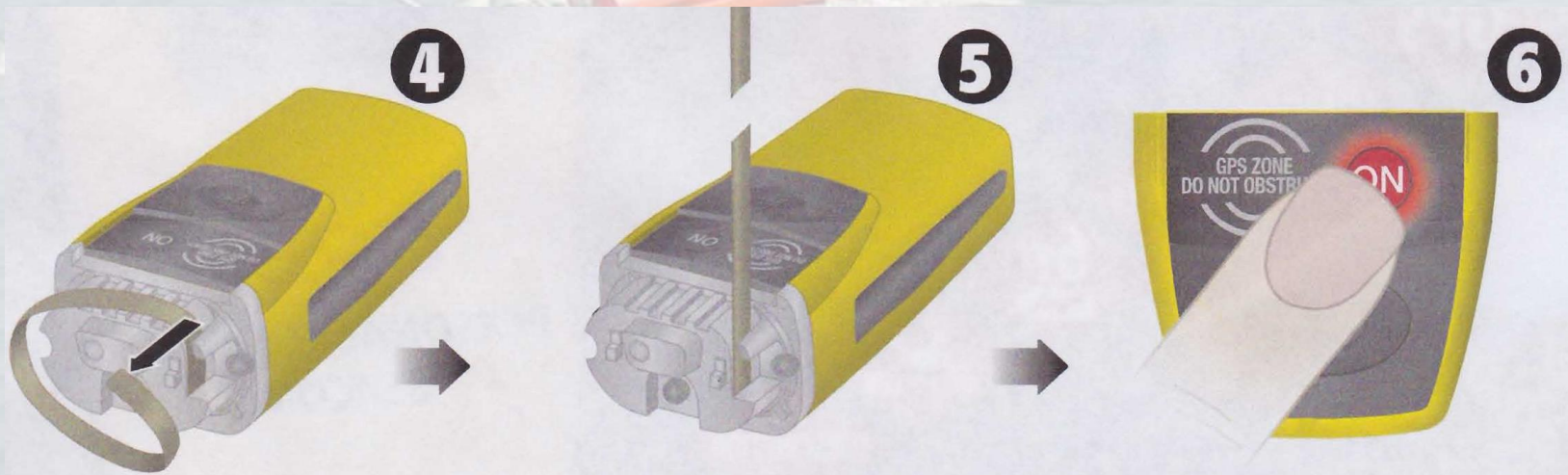

Deactivating

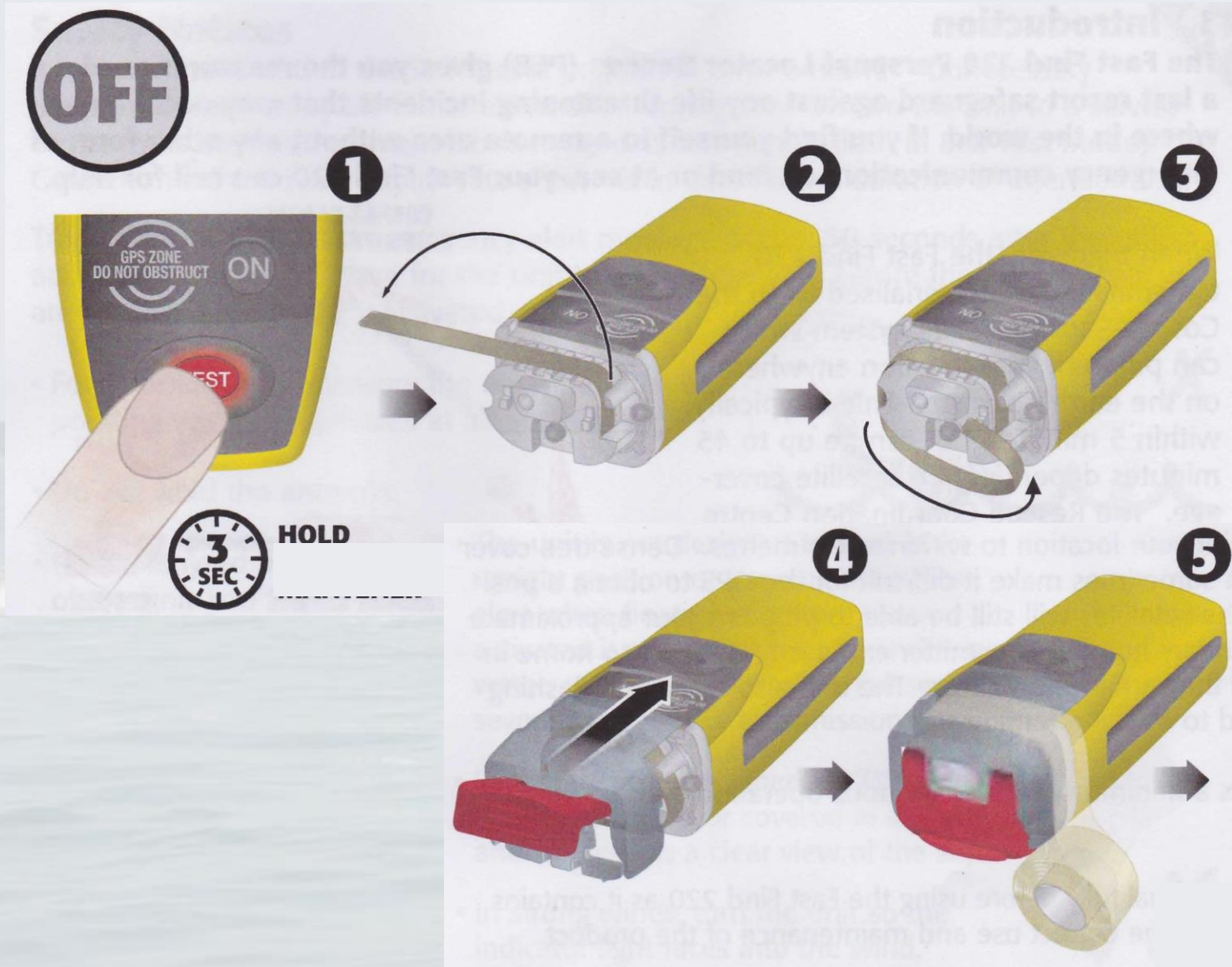

Personal Emergency Position Indicating Radio Beacon (PEPIRB)

Personal Locator Beacon (PLB)

Operates on the 406Mhz global satellite rescue system ensuring that your emergency signal can be sent from anywhere in the world.

They also transmit a 121.5MHz homing signal and the Fastfind Plus version benefits from a dedicated built in GPS sending a highly accurate location position typically +/- 50metres within a few minutes of switching the unit on.

This enables the rescue authorities to greatly reduce their search time. There is also a -40°C battery option for colder climates. The Fastfind is of particular benefit if you are moving from boat to boat or having to work on deck in adverse weather conditions.

It is compact and should be tethered ensuring that you can safely move around without fear of losing the unit.

PEPIRB replacement batteries available upon request from D7.

Registered to an individual by District, including Boat Name.

